

DO NOT SCALE

100
0 10
Millimetres

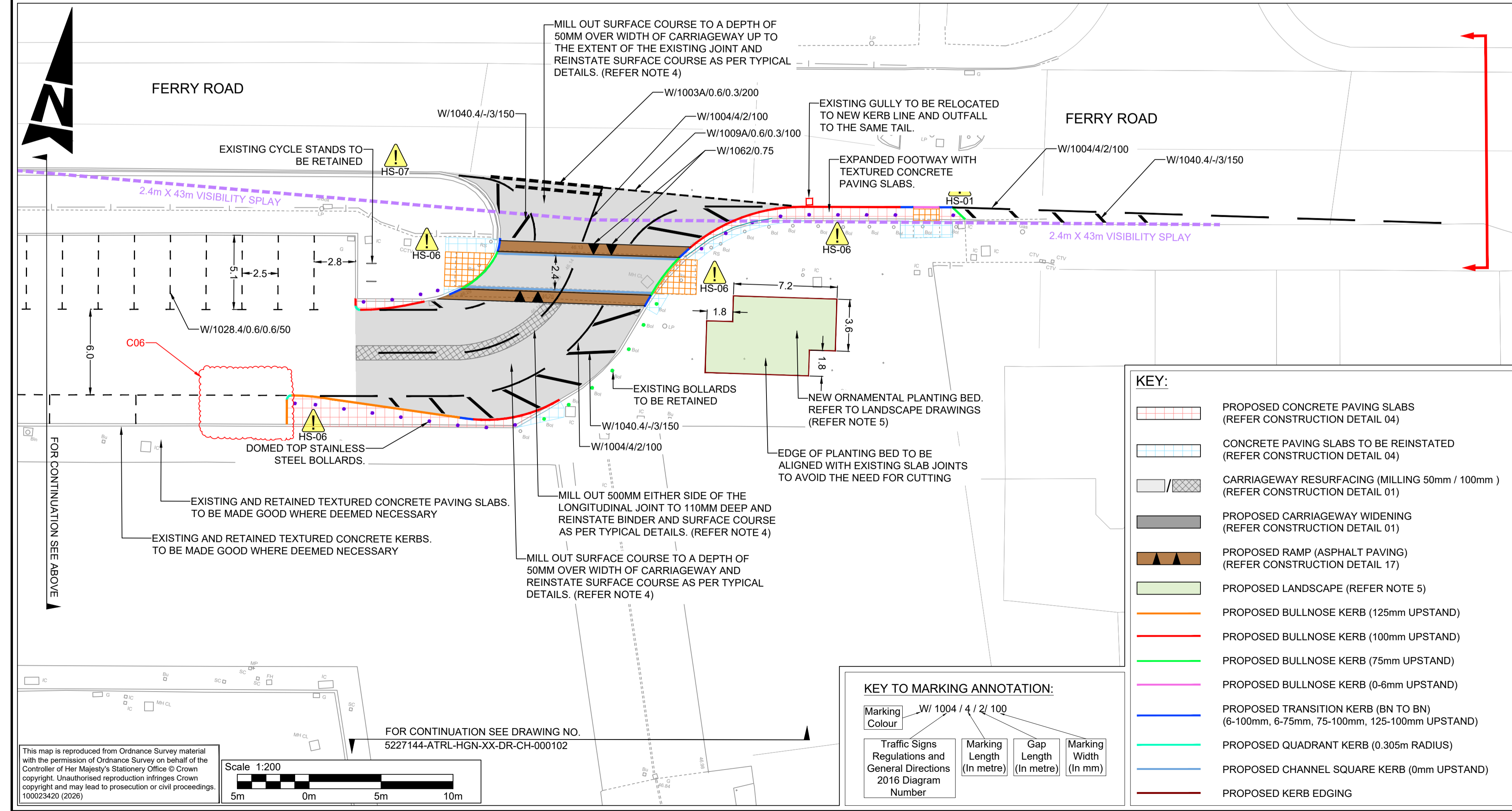

- NOTES:**
- DO NOT SCALE FROM THIS DRAWING.
 - ALL DIMENSIONS ARE IN METRES UNLESS OTHERWISE STATED.
 - FOR SITE CLEARANCE, REFER DRAWING NOS. 5227144-ATRL-HSC-XX-DR-CH-000201 TO 5227144-ATRL-HSC-XX-DR-CH-000202.
 - FOR CONSTRUCTION / TYPICAL DETAILS, REFER DRAWING NOS. 5227144-ATRL-HGN-XX-DE-CH-000001 TO 5227144-ATRL-ELS-XX-DR-LL-000001.
 - FOR LANDSCAPE DRAWINGS, REFER DRAWING NO. 5227144-ATRL-ELS-XX-DR-LL-000001.
 - FOR C2 EXISTING UTILITY INFORMATION, REFER DRAWING NOS. 5227144-ATRL-VUT-XX-DR-CH-002701 TO 5227144-ATRL-VUT-XX-DR-CH-002702.
 - FOR DESIGNER RISK ASSESSMENT, REFER DOCUMENT NO. 5227144-ATRL-GEN-XX-RA-ZS-000001.
 - THE WORKS SHALL BE CONSTRUCTED IN ACCORDANCE WITH THE SPECIFICATION FOR HIGHWAY WORKS.
 - ALL ROAD MARKINGS SHALL BE IN ACCORDANCE WITH THE TRAFFIC SIGNS REGULATIONS AND GENERAL DIRECTION 2016.
 - ALL ROAD MARKINGS SHALL BE EXTRUDED THERMOPLASTIC MATERIAL.
 - THE SUBSTRATE SHALL BE INSPECTED AND ANY DEFECTS RECTIFIED TO SHW CL 946 PRIOR TO LAYING ANY NEW PAVEMENT LAYERS.
 - CONTRACTOR TO ESTABLISH LOCATION OF SERVICES PRIOR TO BREAKING GROUND.
 - ALL PAVING WORKS SHALL BE CARRIED OUT IN ACCORDANCE WITH BS594987.
 - THE PROPOSED KERBS TO BE TIED IN TO THE EXISTING KERBS AS DIRECTED BY THE ENGINEER.

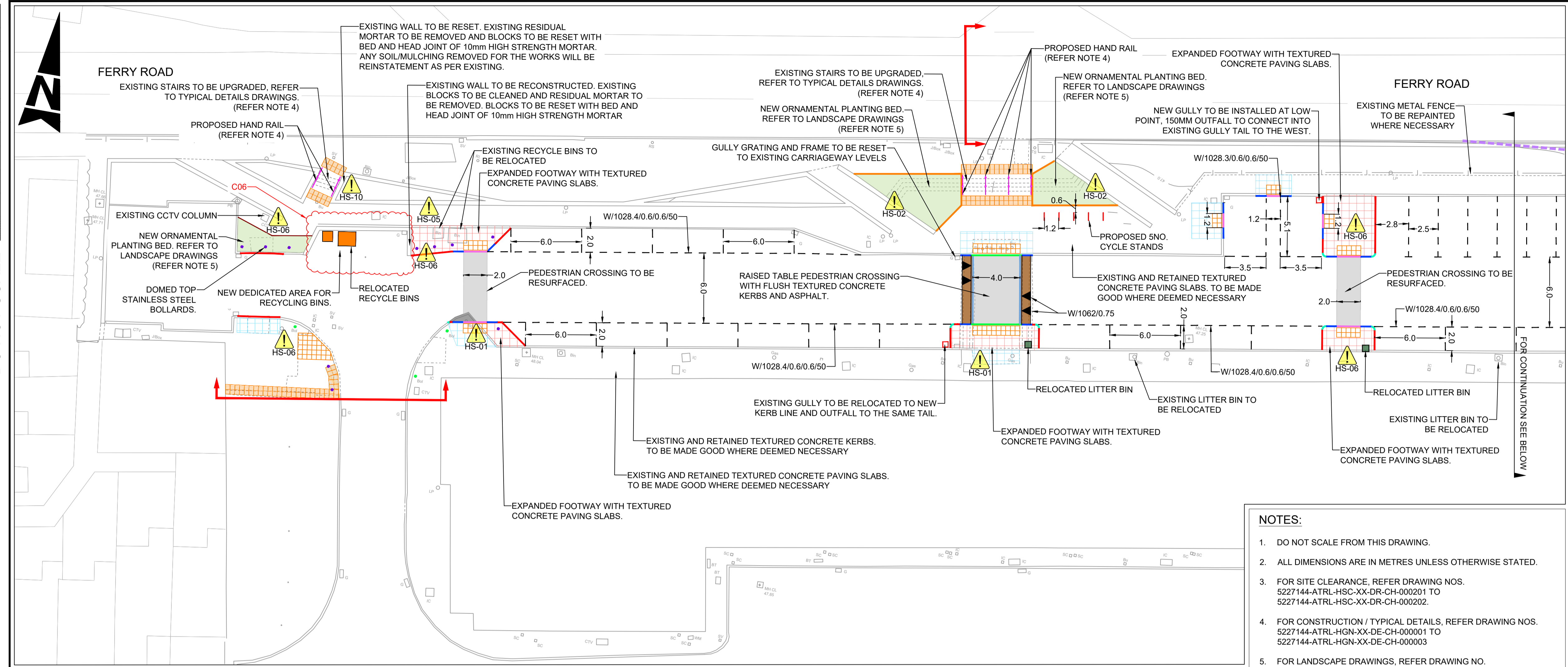
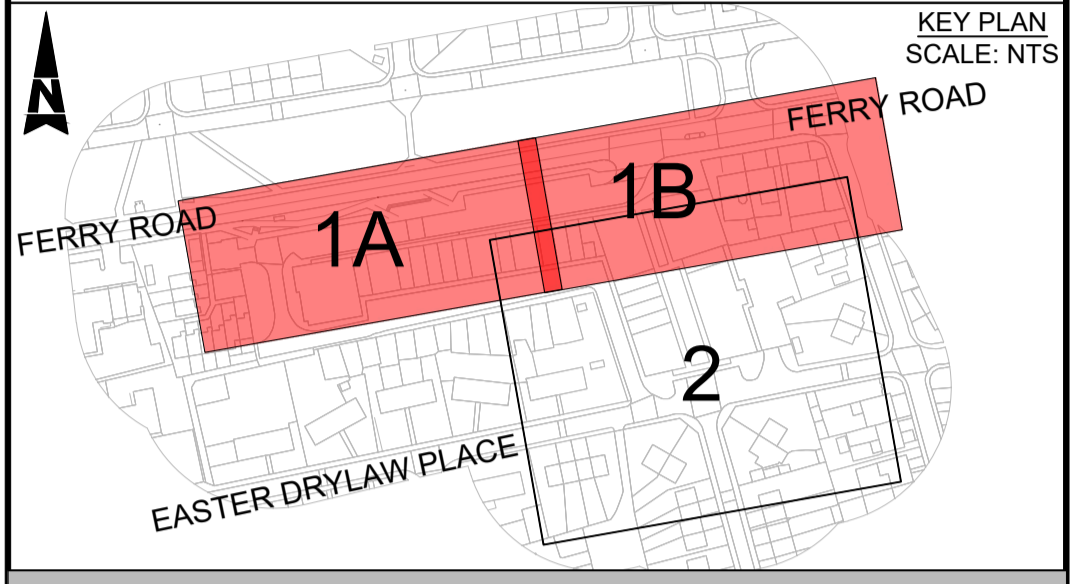
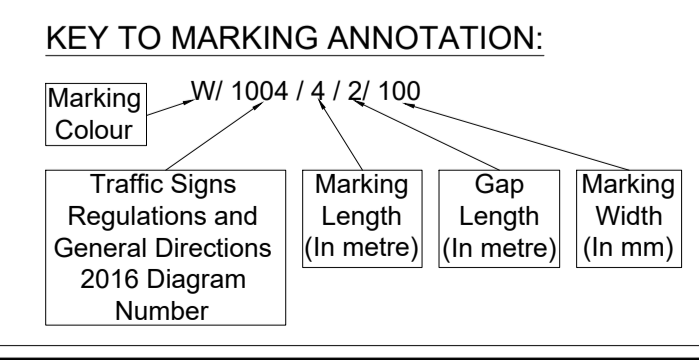
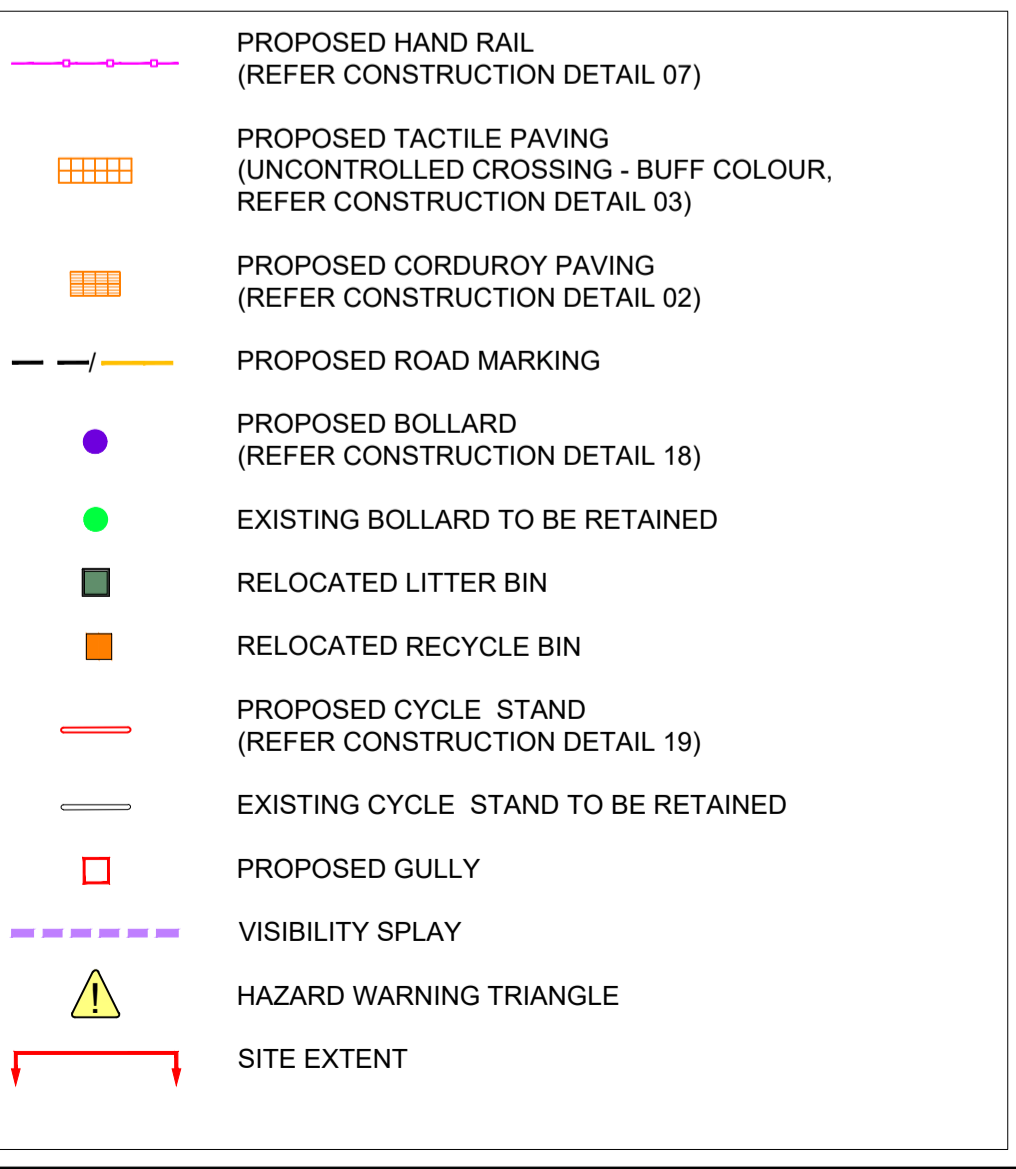
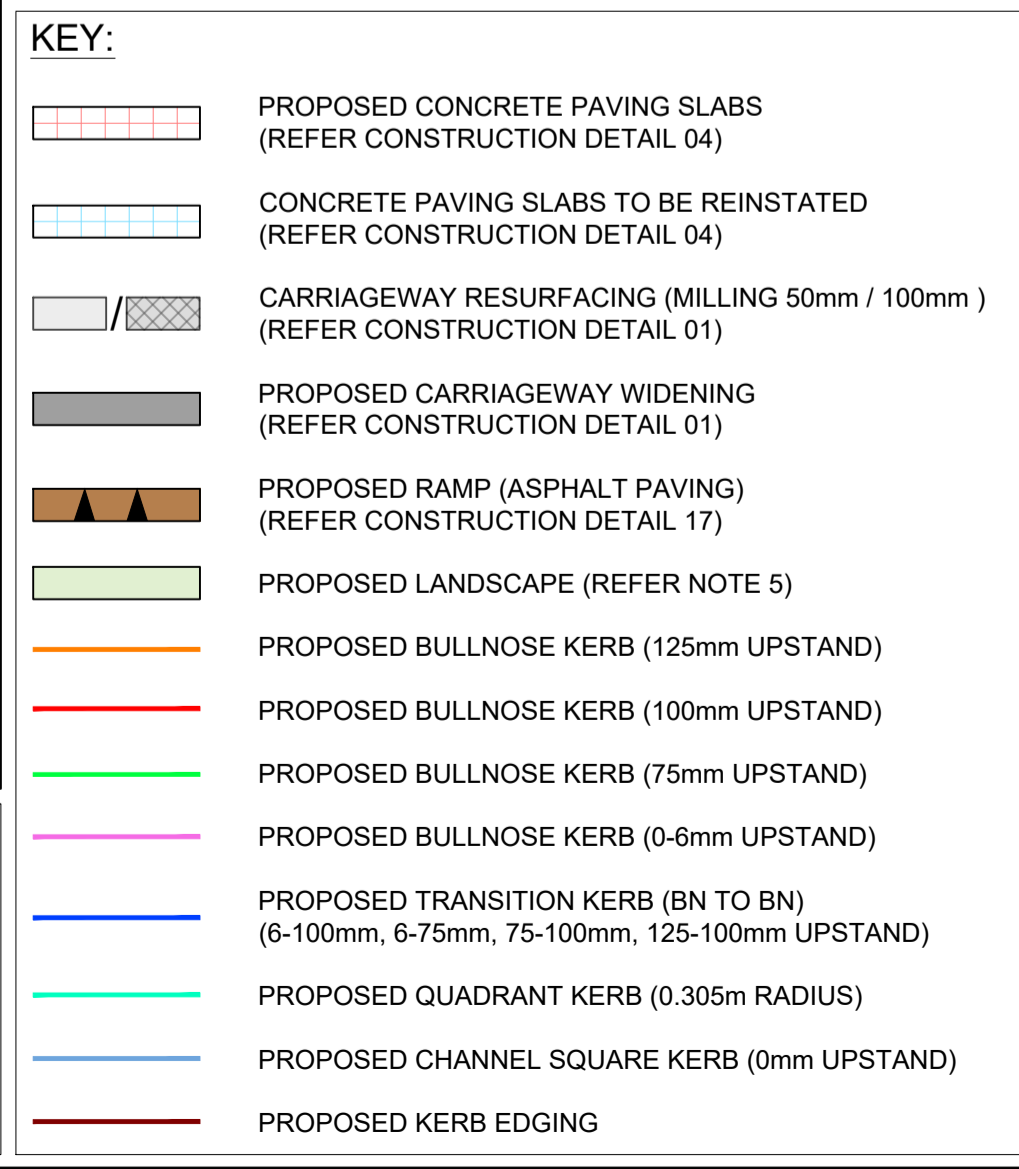

SAFETY, HEALTH AND ENVIRONMENTAL INFORMATION

In addition to the hazards/risks normally associated with the types of work detailed on this drawing, note the following significant residual risks (Reference shall also be made to the design hazard log).

Construction
 HS-01: Existing utility (High pressure gas) present within site extents, HS-02 & HS10: Removing the existing stairs for landscape works, HS-05: Moving the waste and recycling bins to the new location, HS-06: Existing utilities present within site extents, HS-07: Vegetation clearance

Maintenance / Cleaning
 --

Use
 --

Decommissioning / Demolition
 --

Description FOR RSA COMMENTS

Status	Revision	Drawn	Checked	Reviewed	Authorised	Issue Date
A1	C02	KJ	JR	RC	RC	09/12/25

Description POST CLIENT COMMENTS

Status	Revision	Drawn	Checked	Reviewed	Authorised	Issue Date
A1	C03	KJ	JR	RC	RC	27/01/26

Description POST CLIENT COMMENTS

Status	Revision	Drawn	Checked	Reviewed	Authorised	Issue Date
A1	C04	KJ	JR	RC	RC	03/03/26

Description DISABLED BAY MARKINGS UPDATED

Status	Revision	Drawn	Checked	Reviewed	Authorised	Issue Date
A1	C05	SM	RC	AR	RC	20/04/26

Description POST CLIENT COMMENTS

Status	Revision	Drawn	Checked	Reviewed	Authorised	Issue Date
A1	C06	AT	RC	EM	RC	05/05/26

Status
 A1 **Drawing Suitability**
FOR CONSTRUCTION

AtkinsRéalis

Stamp Office
 10 Waterloo Place
 Edinburgh
 EH1 3EG
 United Kingdom

www.AtkinsRealis.com

© AtkinsRéalis (2025)

EDINBURGH
 THE CITY OF EDINBURGH COUNCIL

Project Title
 DRYLAW SHOPPING CENTRE IMPROVEMENTS PROJECT

Drawing Title
 GENERAL ARRANGEMENT

Drawing Number
 Project 5227144 XX

Original Size: A1

Scale: 1:200

Project Ref. No.: 5227144

Sheet: 1 of 2

Rev: C06

Originator: ATRL - HGN - DR - CH - 000101

Functional Breakdown: ATRL - HGN - DR - CH - 000101

Form: ATRL - HGN - DR - CH - 000101

Discipline: ATRL - HGN - DR - CH - 000101

Number: ATRL - HGN - DR - CH - 000101

This map is reproduced from Ordnance Survey material with the permission of Ordnance Survey on behalf of the Controller of Her Majesty's Stationery Office © Crown copyright. Unauthorised reproduction infringes Crown copyright and may lead to prosecution or civil proceedings. 100023420 (2026)

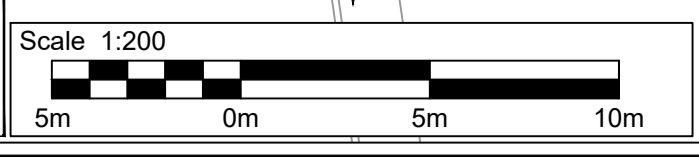

FOR CONTINUATION SEE DRAWING NO. 5227144-ATRL-HGN-XX-DR-CH-000102

FOR CONTINUATION SEE ABOVE

FOR CONTINUATION SEE BELOW

DO NOT SCALE

0 10 100
Millimetres

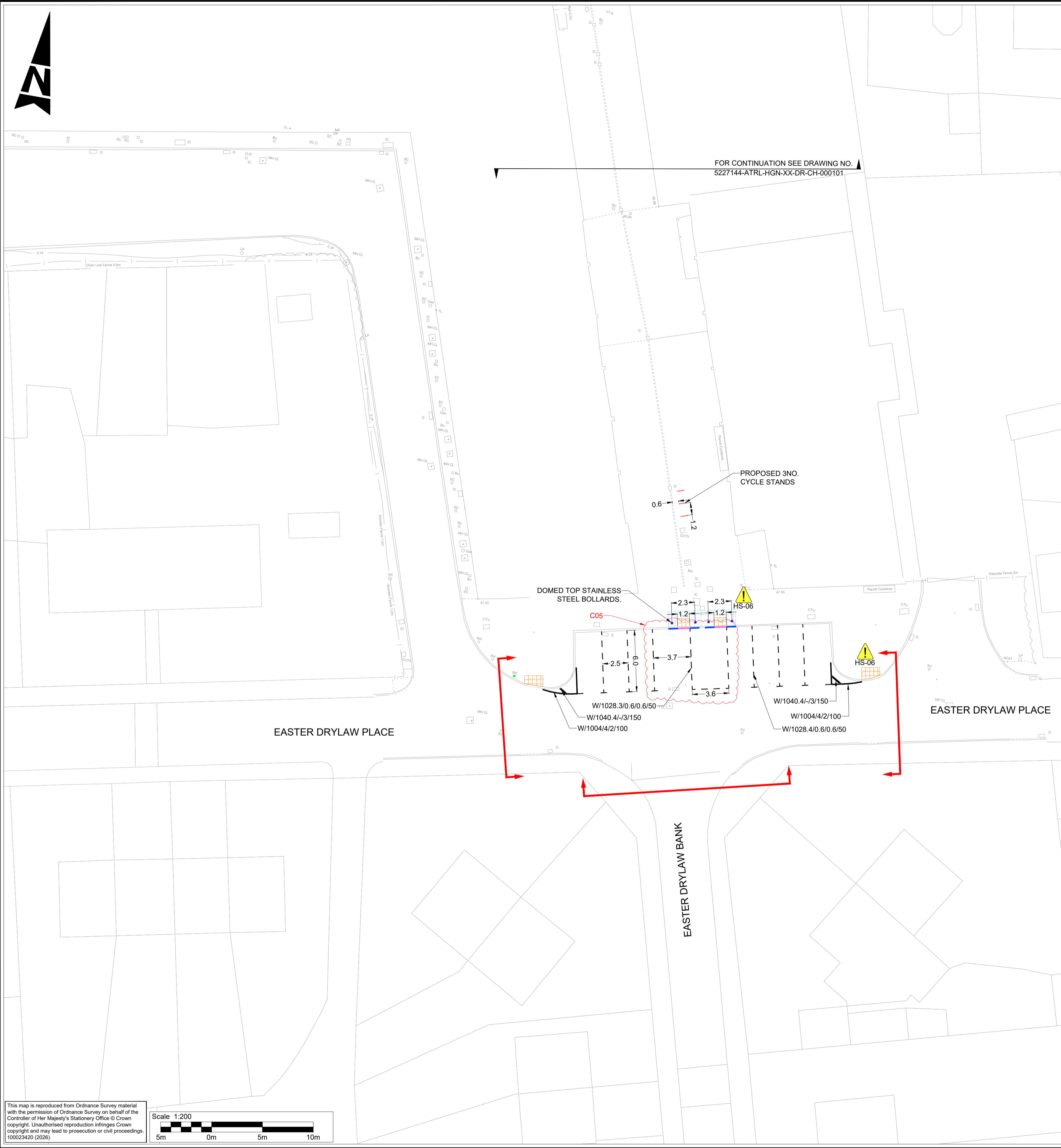
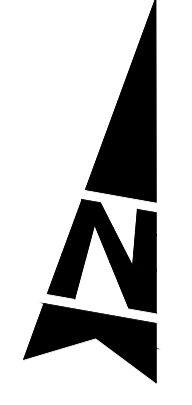

- NOTES:**
- DO NOT SCALE FROM THIS DRAWING.
 - ALL DIMENSIONS ARE IN METRES UNLESS OTHERWISE STATED.
 - FOR SITE CLEARANCE, REFER DRAWING NOS. 5227144-ATRL-HSC-XX-DR-CH-000201 TO 5227144-ATRL-HSC-XX-DR-CH-000202.
 - FOR CONSTRUCTION / TYPICAL DETAILS, REFER DRAWING NOS. 5227144-ATRL-HGN-XX-DE-CH-000001 TO 5227144-ATRL-HGN-XX-DE-CH-000003.
 - FOR LANDSCAPE DRAWINGS, REFER DRAWING NO. 5227144-ATRL-ELS-XX-DR-LL-000001.
 - FOR C2 EXISTING UTILITY INFORMATION, REFER DRAWING NOS. 5227144-ATRL-VUT-XX-DR-CH-002701 TO 5227144-ATRL-VUT-XX-DR-CH-002702.
 - FOR DESIGNER RISK ASSESSMENT, REFER DOCUMENT NO. 5227144-ATRL-GEN-XX-RA-ZS-000001.
 - THE WORKS SHALL BE CONSTRUCTED IN ACCORDANCE WITH THE SPECIFICATION FOR HIGHWAY WORKS.
 - ALL ROAD MARKINGS SHALL BE IN ACCORDANCE WITH THE TRAFFIC SIGNS REGULATIONS AND GENERAL DIRECTION 2016.
 - ALL ROAD MARKINGS SHALL BE EXTRUDED THERMOPLASTIC MATERIAL.
 - THE SUBSTRATE SHALL BE INSPECTED AND ANY DEFECTS RECTIFIED TO SHW CL 946 PRIOR TO LAYING ANY NEW PAVEMENT LAYERS.
 - CONTRACTOR TO ESTABLISH LOCATION OF SERVICES PRIOR TO BREAKING GROUND.
 - ALL PAVING WORKS SHALL BE CARRIED OUT IN ACCORDANCE WITH BS594987.
 - THE PROPOSED KERBS TO BE TIED IN TO THE EXISTING KERBS AS DIRECTED BY THE ENGINEER.

- KEY:**
- PROPOSED CONCRETE PAVING SLABS (REFER CONSTRUCTION DETAIL 04)
 - CONCRETE PAVING SLABS TO BE REINSTATED (REFER CONSTRUCTION DETAIL 04)
 - CARRIAGEWAY RESURFACING (MILLING 50mm / 100mm) (REFER CONSTRUCTION DETAIL 01)
 - PROPOSED CARRIAGEWAY WIDENING (REFER CONSTRUCTION DETAIL 01)
 - PROPOSED RAMP (ASPHALT PAVING) (REFER CONSTRUCTION DETAIL 17)
 - PROPOSED LANDSCAPE (REFER NOTE 5)
 - PROPOSED BULLNOSE KERB (125mm UPSTAND)
 - PROPOSED BULLNOSE KERB (100mm UPSTAND)
 - PROPOSED BULLNOSE KERB (75mm UPSTAND)
 - PROPOSED BULLNOSE KERB (0-6mm UPSTAND)
 - PROPOSED TRANSITION KERB (BN TO BN) (6-100mm, 6-75mm, 75-100mm, 125-100mm UPSTAND)
 - PROPOSED QUADRANT KERB (0.305m RADIUS)
 - PROPOSED CHANNEL SQUARE KERB (0mm UPSTAND)
 - PROPOSED KERB EDGING
 - PROPOSED HAND RAIL (REFER CONSTRUCTION DETAIL 07)
 - PROPOSED TACTILE PAVING (UNCONTROLLED CROSSING - BUFF COLOUR, REFER CONSTRUCTION DETAIL 03)
 - PROPOSED CORDUROY PAVING (REFER CONSTRUCTION DETAIL 02)
 - PROPOSED ROAD MARKING
 - PROPOSED BOLLARD (REFER CONSTRUCTION DETAIL 18)
 - EXISTING BOLLARD TO BE RETAINED
 - RELOCATED LITTER BIN
 - RELOCATED RECYCLE BIN
 - PROPOSED CYCLE STAND (REFER CONSTRUCTION DETAIL 19)
 - EXISTING CYCLE STAND TO BE RETAINED
 - PROPOSED GULLY
 - VISIBILITY SPLAY
 - HAZARD WARNING TRIANGLE
 - SITE EXTENT

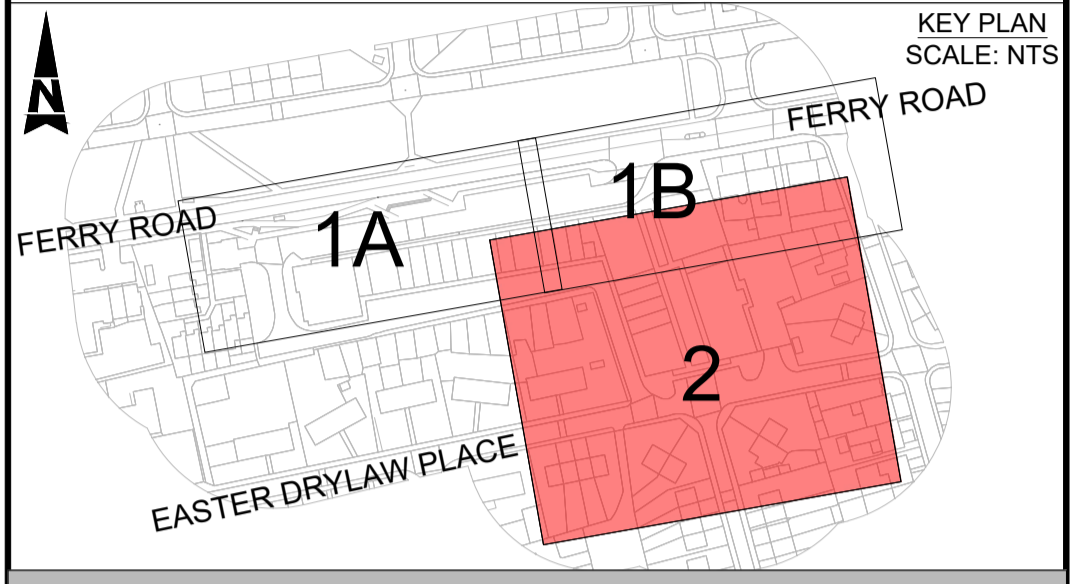
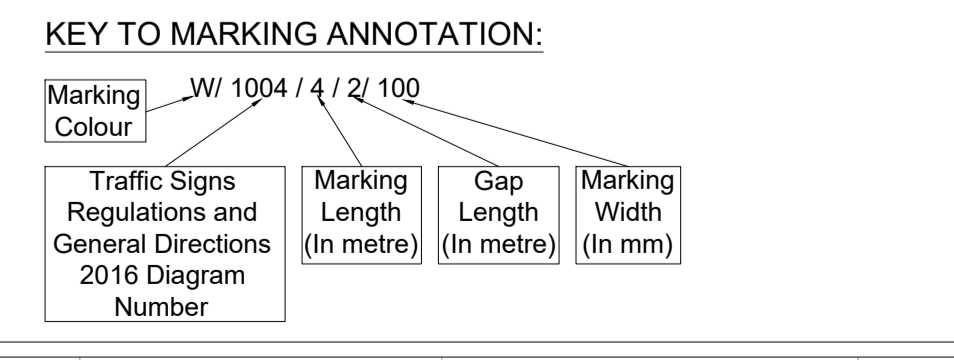

SAFETY, HEALTH AND ENVIRONMENTAL INFORMATION

In addition to the hazards/risks normally associated with the types of work detailed on this drawing, note the following significant residual risks (Reference shall also be made to the design hazard log).

Construction						
HS-01: Existing utility (High pressure gas) present within site extents, HS-02 & HS10: Removing the existing stairs for landscape works, HS-05: Moving the waste and recycling bins to the new location, HS-06: Existing utilities present within site extents, HS-07: Vegetation clearance						
Maintenance / Cleaning						
--						
Use						
--						
Decommissioning / Demolition						
--						

Description FOR CONSTRUCTION						
Status	Revision	Drawn	Checked	Reviewed	Authorised	Issue Date
A1	C01	KJ	JR	RC	RC	09/12/25

Description FOR RSA COMMENTS						
Status	Revision	Drawn	Checked	Reviewed	Authorised	Issue Date
A1	C02	KJ	JR	RC	RC	15/01/26

Description POST CLIENT COMMENTS						
Status	Revision	Drawn	Checked	Reviewed	Authorised	Issue Date
A1	C03	KJ	JR	RC	RC	27/01/26

Description POST CLIENT COMMENTS						
Status	Revision	Drawn	Checked	Reviewed	Authorised	Issue Date
A1	C04	KJ	JR	RC	RC	03/03/26

Description DISABLED BAY MARKINGS UPDATED						
Status	Revision	Drawn	Checked	Reviewed	Authorised	Issue Date
A1	C05	SM	RC	AR	RC	17/04/26

Status	Drawing Suitability					
A1	FOR CONSTRUCTION					

AtkinsRéalis

Stamp Office
10 Waterloo Place
Edinburgh
EH1 3EG
United Kingdom

© AtkinsRéalis (2025) www.AtkinsRealis.com

EDINBURGH
THE CITY OF EDINBURGH COUNCIL

Project Title DRYLAW SHOPPING CENTRE IMPROVEMENTS PROJECT

Drawing Title GENERAL ARRANGEMENT

Drawing Number		Project		Originator		Functional Breakdown	
5227144		XX		- ATRL - HGN -		- DR - CH - 000102	
Spatial Breakdown		Form		Discipline		Number	
Original Size: A1		Scale: 1:200		Project Ref. No: 5227144		Sheet: 2 of 2	
						Rev: C05	

This map is reproduced from Ordnance Survey material with the permission of Ordnance Survey on behalf of the Controller of Her Majesty's Stationery Office © Crown copyright. Unauthorised reproduction infringes Crown copyright and may lead to prosecution or civil proceedings. 100023420 (2026)

