

Client:

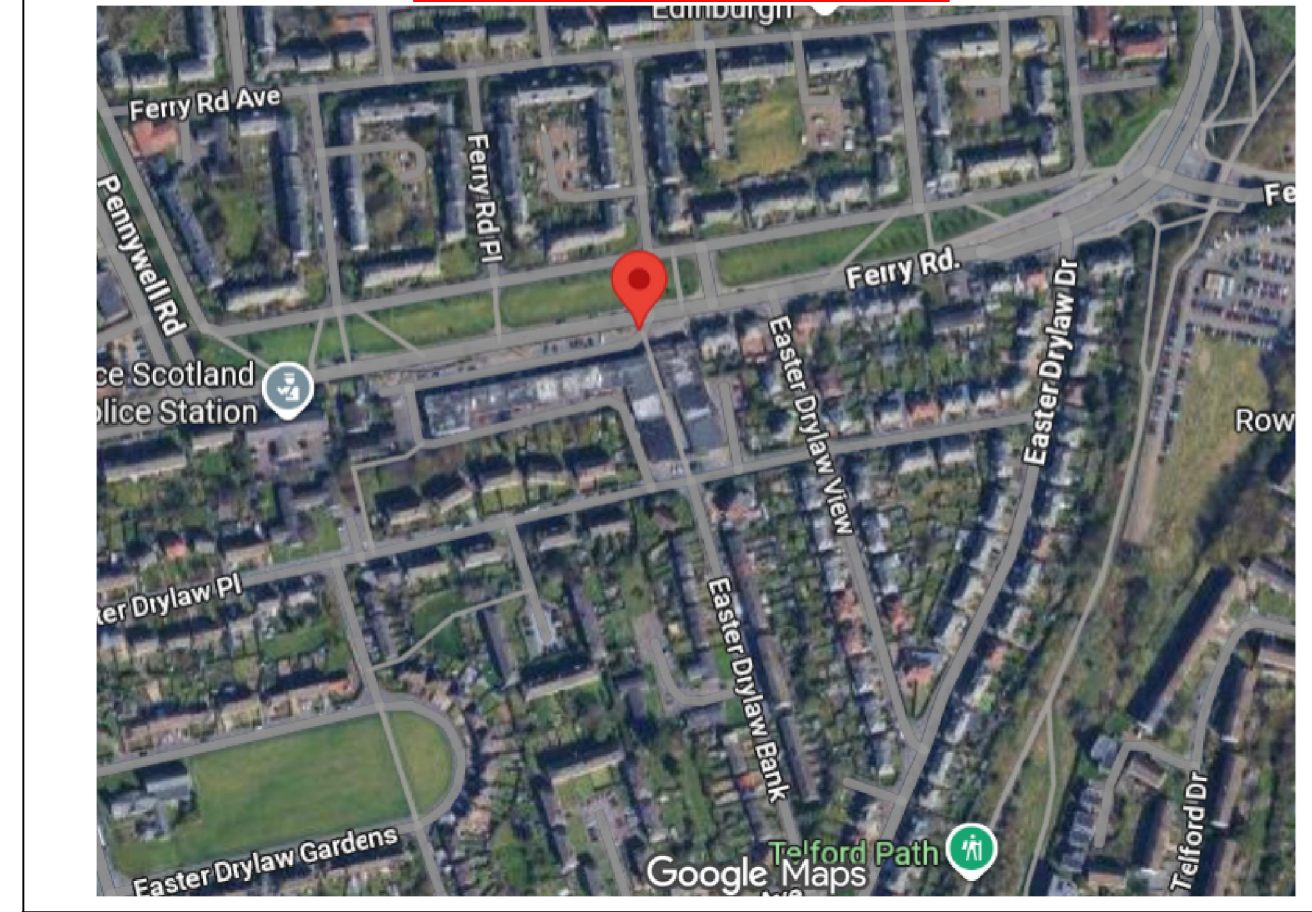

Drawing by **C.Stirling** Date **13/04/26**  
 Approved by **R.Johnstone** Date **13/04/26**  
 Issue Number - 1

**Location Overview**



**Site Address**

**DRYLAW SHOPPING CENTRE**

**TM Setup**

**Speed Limit**      **Temporary Speed Limit**

Repeat every 350m alternative sides

**Site Details**

**WORKFORCE IN ROAD SLOW**

Sign should be set out at a safe location, where you can stop safely and erect the sign i.e. road 40 mph or under, lay by or where a hard shoulder is available, this should be used when traffic management personnel are setting out roadworks in the live lanes.



**ADF - N/A**

**KEY**

- ▶ Traffic sign
- Traffic cone/cylinder
- ← Traffic signals to Diagram 3000.1
- ⊞ Traffic signals controller
- ⊕ Stop/Go board (P7023/P7024)
- Temporary reflective road stud
- High intensity flashing beacon complying with Regulation 54 mounted at a height between 800mm and 1500mm above the road surface
- Pedestrian barrier
- ▨ Cable crossing protector
- ▨ Temporary vehicle restraint barrier

Drawing - Not To Scale

Drawing Number - **DMTM - DRYLAW SHOPPING CNTR - TM03**

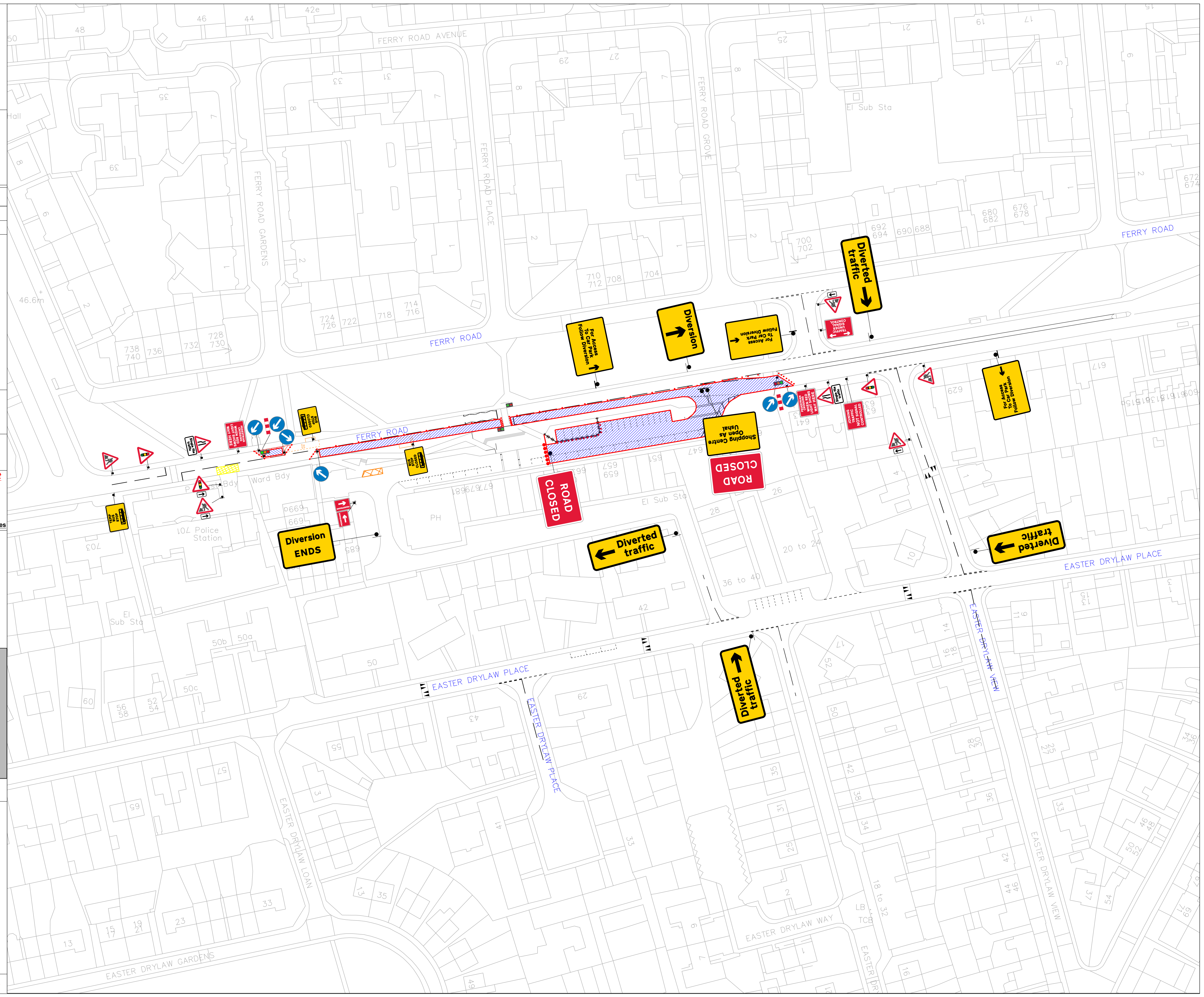

Client:



Drawing by **C.Stirling** Date **13/04/26**  
 Approved by **R.Johnstone** Date **13/04/26**  
 Issue Number - 1

**Location Overview**

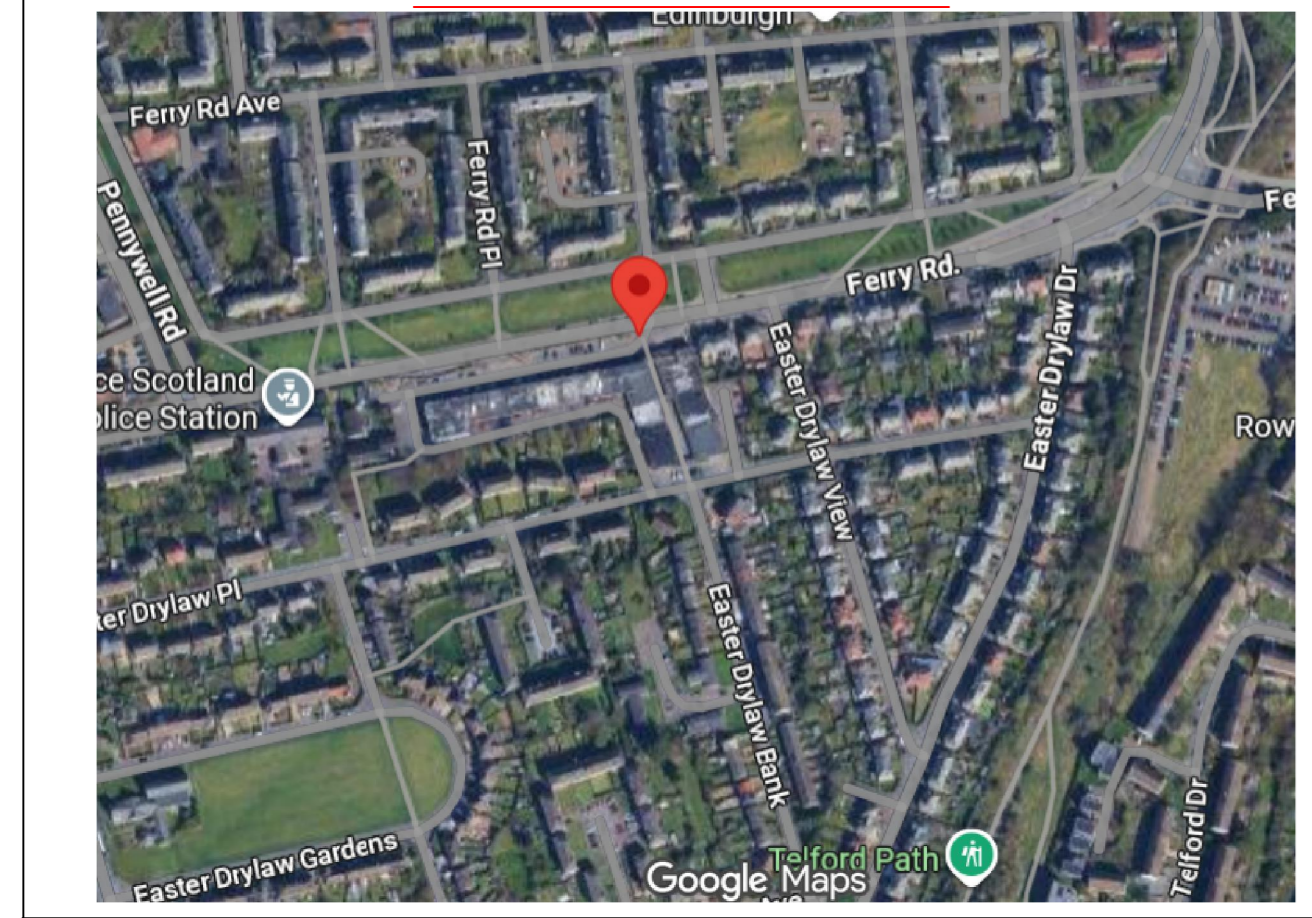

**Site Address**

**DRYLAW SHOPPING CENTRE**

**TM Setup**

**Speed Limit**      **Temporary Speed Limit**

Repeat every 350m alternative sides

**Site Details**

**WORKFORCE IN ROAD SLOW**

Sign should be set out at a safe location, where you can stop safely and erect the sign i.e. road 40 mph or under, lay by or where a hard shoulder is available, this should be used when traffic management personnel are setting out roadworks in the live lanes.



**ADF - N/A**

**KEY**

- ▶ Traffic sign
- Traffic cone/cylinder
- ← Traffic signals to Diagram 3000.1
- ☐ Traffic signals controller
- ⊕ Stop/Go board (P7023/P7024)
- Temporary reflective road stud
- ⚡ High intensity flashing beacon complying with Regulation 54 mounted at a height between 800mm and 1500mm above the road surface
- Pedestrian barrier
- ▨ Cable crossing protector
- ▨ Temporary vehicle restraint barrier

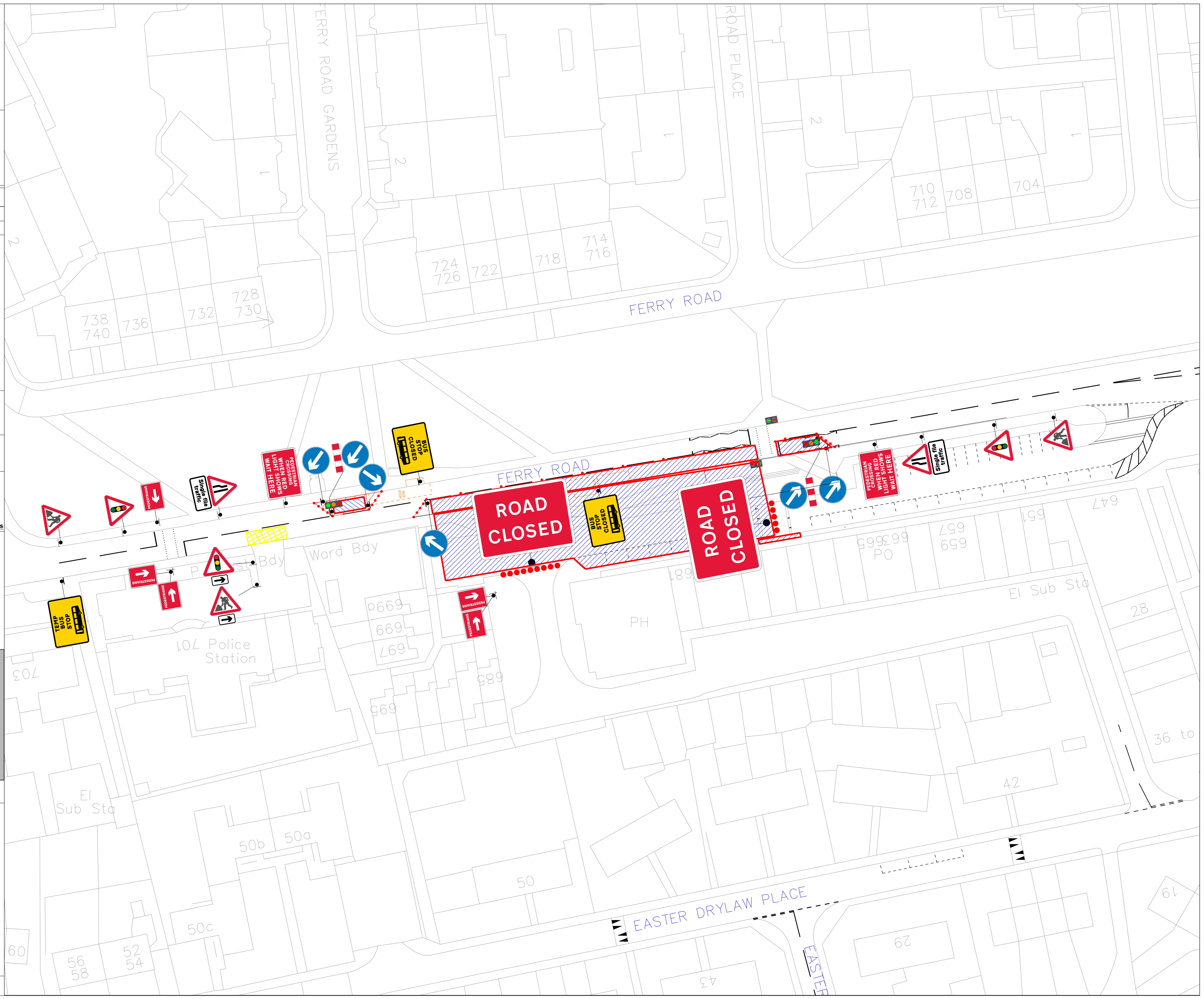
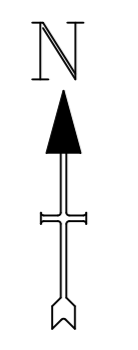

**Client:**



Drawing by	<b>C.Stirling</b>	Date	<b>13/04/26</b>
Approved by	<b>R.Johnstone</b>	Date	<b>13/04/26</b>

Issue Number - 1

**Location Overview**

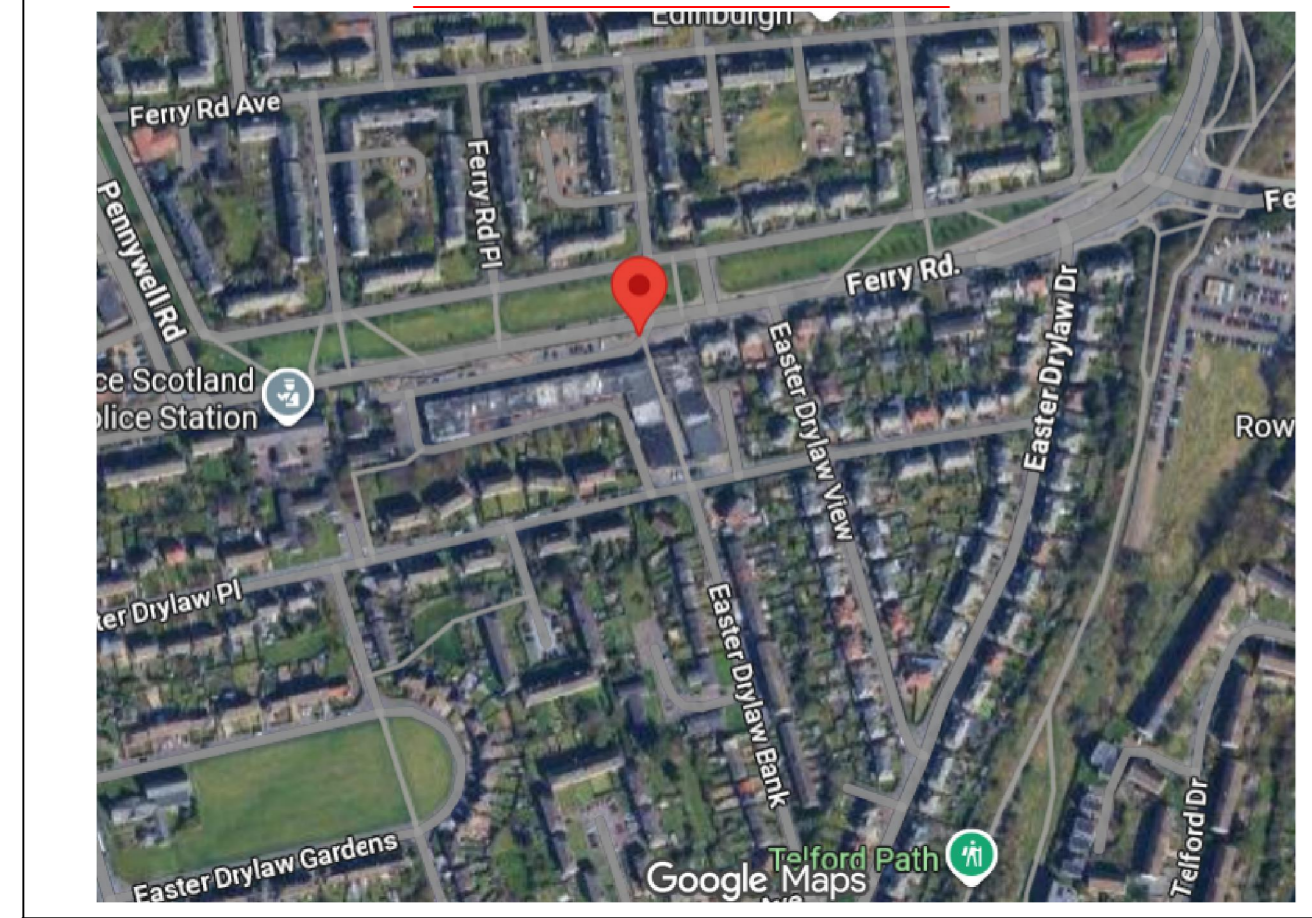

**Site Address**

**DRYLAW SHOPPING CENTRE**

**TM Setup**

**Speed Limit**

**Temporary Speed Limit**

Repeat every 350m alternative sides

**Site Details**

**WORKFORCE IN ROAD SLOW**

Sign should be set out at a safe location, where you can stop safely and erect the sign i.e. road 40 mph or under, lay by or where a hard shoulder is available, this should be used when traffic management personnel are setting out roadworks in the live lanes.



**ADF - N/A**

**KEY**

- ▶ Traffic sign
- Traffic cone/cylinder
- ← Traffic signals to Diagram 3000.1
- ☐ Traffic signals controller
- ⊕ Stop/Go board (P7023/P7024)
- Temporary reflective road stud
- ▶ High intensity flashing beacon complying with Regulation 54 mounted at a height between 800mm and 1500mm above the road surface
- Pedestrian barrier
- ▨ Cable crossing protector
- ▬ Temporary vehicle restraint barrier

