

NEWSLETTER 04

APRIL 2026

This month's update on the Moredun Multi Blocks project includes:

- Planning application status
- **Proposed changes to roads, parking, and landscaping**
- Information on resident sessions – past and upcoming



Planning Application

Planning Application Submitted

We want to let you know that we have now officially submitted the planning application for the proposed works. The Council's planning department has checked and accepted the application.

What This Means

A planning application is a formal request for permission to carry out building work or changes. The Council will review the plans and decide whether to approve them. Before they make a decision, they ask for comments from the public – including you.

Planning Decision Process

The Council will carefully review the planning application and consult with different departments to make sure everything is considered. This includes teams like Waste Services, Parks and Green Spaces, and Roads and Transport, who check safety, the environment, and community needs.

After this review, the Planning Committee – a group of elected councillors – will make the final decision based on the plans, expert advice, and the comments from residents.



Shape the Future

How to View and Comment

All proposed plans, drawings, and images can be viewed online using the council's planning portal. Follow the steps in this leaflet to access the application. Select the **Documents** tab to view the proposals and use the **Comments** section to share your views.

Your Voice Matters

Your views are an important part of the planning process. The Council will read and consider what residents say before making any decision. Sharing your thoughts helps shape the future of your community. Whether you support the plans, have concerns, or want to suggest improvements, your input makes a real difference.

Please note

The project is split into two separate applications:

- **Application A** covers: Moredun House, Marytree House, Little France House, Castleview House plus surrounding areas
- **Application B** covers: Moncrieffe House, Forteviot House plus surrounding areas



OPPORTUNITY TO VIEW & COMMENT:

1. Planning applications can be viewed on the Planning Portal at citydev-portal.edinburgh.gov.uk using 'Simple Search' and the reference numbers below:
 - Application A: **26/00961/FUL**
 - Application B: **26/00959/FUL**
2. This will take you directly to the [planning application page](#).

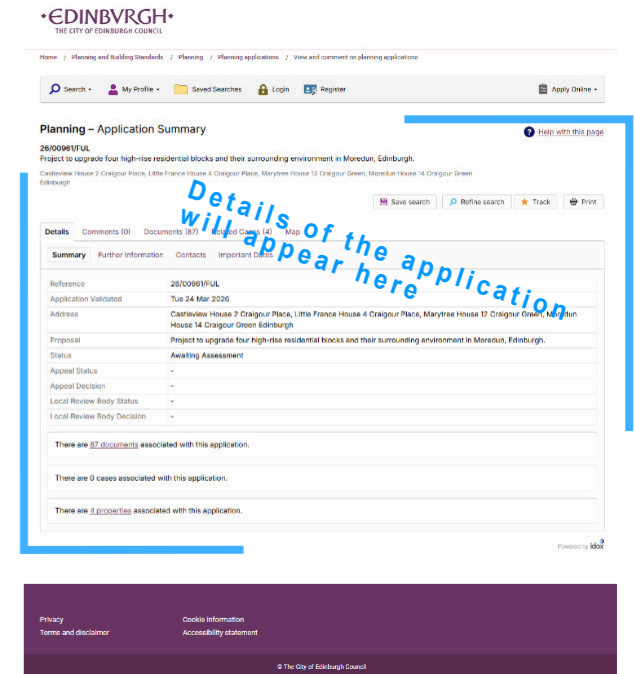
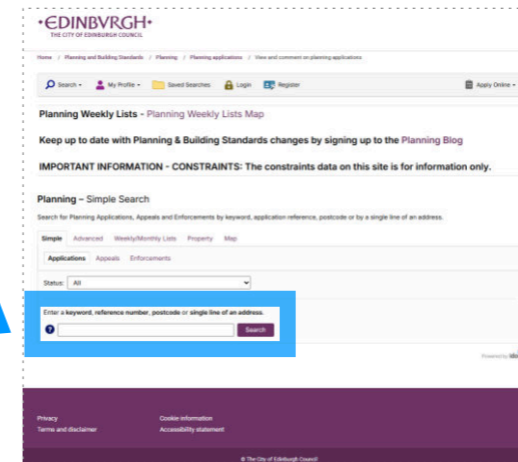

3. Click the **'Documents'** tab to see the full proposal.
4. Use the **'Comment'** tab section to write your thoughts.

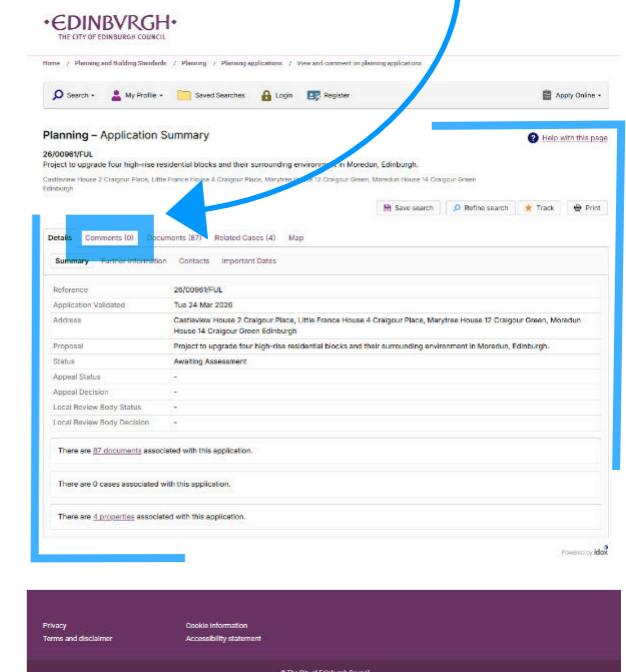
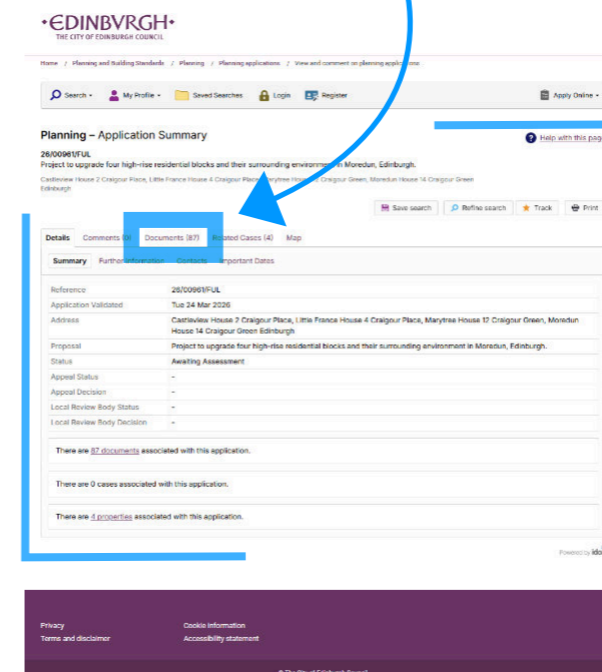

Timeline of the engagements

- PAST -

This timeline shows the consultation activities we've completed so far. These include sharing newsletters, hosting on-site consultation events at the blocks, and holding meetings with the Moredun Multis Tenants Association.

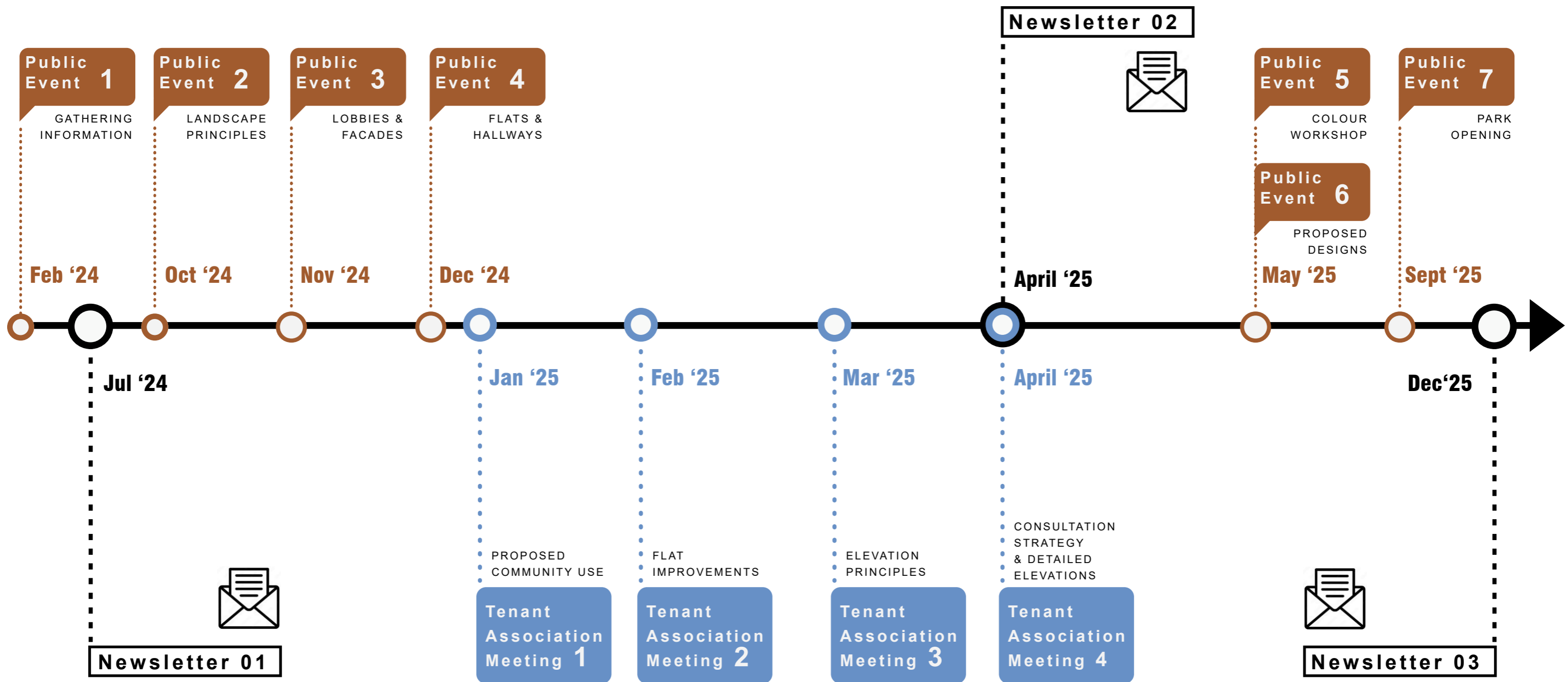

Timeline of the engagements

- FUTURE -

Looking ahead, this timeline outlines upcoming activities such as future newsletters, consultation sessions, and ways for residents to stay engaged.

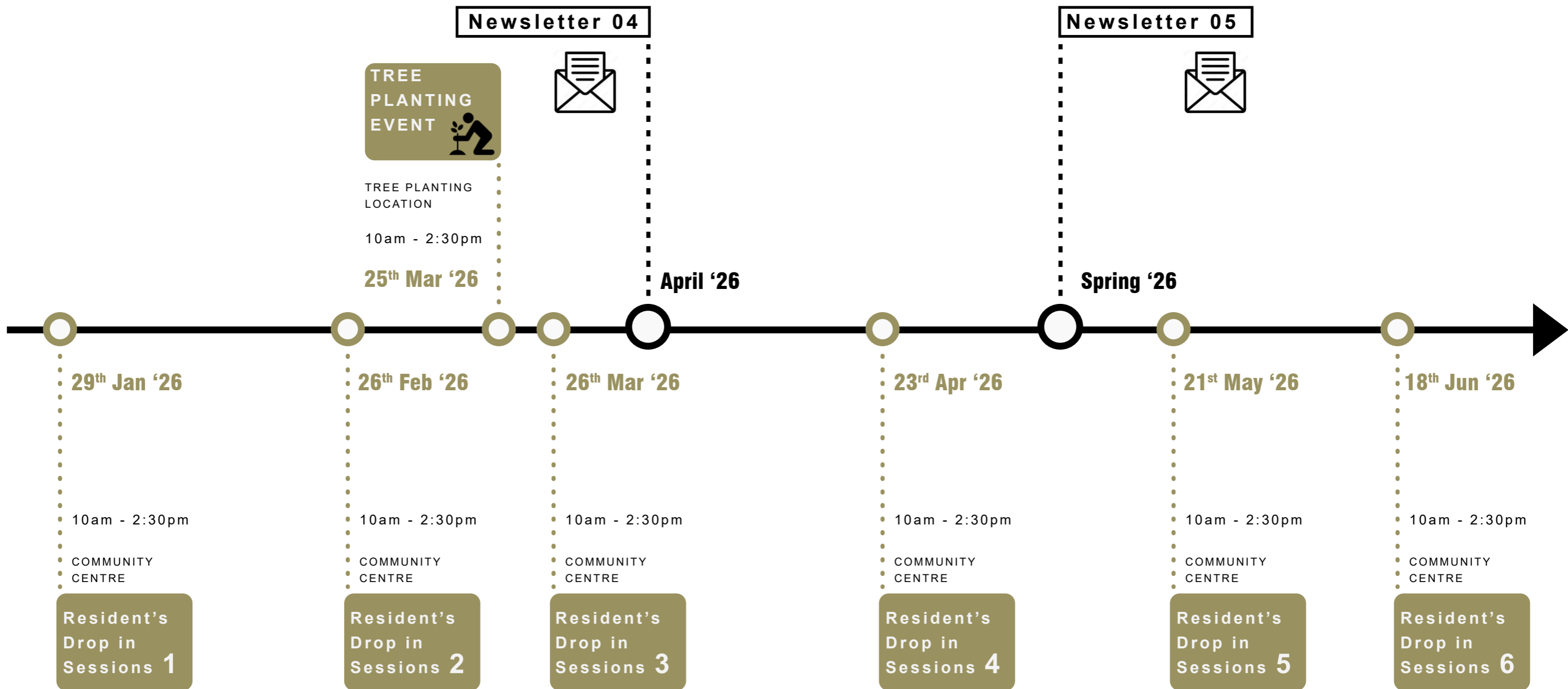



Landscape Proposals

LANDSCAPE DESIGN.

Improvements to the external surrounding of the blocks are also planned, these can be summarised by 4 main principles:

Inclusive for All

- More parking spaces for people living with disabilities
- Ramps for wheelchairs and people who find walking difficult

Flood Resilient

- Special features like basins, swales, and rain gardens to soak up rain
- Meadow-style planting to help absorb water
- Paving that lets water pass through in the right places
- More trees to slow down rainwater

Well Connected

- Bin stores close to building entrances
- Paths that link all the buildings and shared spaces
- Car parks connected by new roads and paths
- Better access to the nearby park

Nature Enhancement

- Changing the road layout to make room for more plants
- Planting along paths to make the area feel softer and greener
- Adding trees and plants that support wildlife and biodiversity

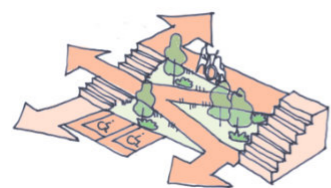

Inclusive for All

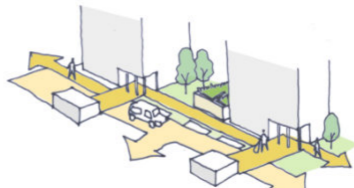

Well Connected



Flood Resilient



Nature Enhancement



Photos from Tree Planting Event (25th March)



EXAMPLES OF New Entrance Space at Marytree House.

Summary of Proposals

LANDSCAPE DESIGN.

Alongside these improvements, we are proposing new accessible routes through the area, as well as a new gateway feature to the park to create a clearer, more welcoming entrance.

Key focus areas include the pedestrian routes between Little France and Marytree House, and around Forteviot and Moncrieffe House. These will feature enhanced ramped access, additional soft planting, and new seating, making it easier and more comfortable for residents and visitors to move between the buildings, car park, and park.

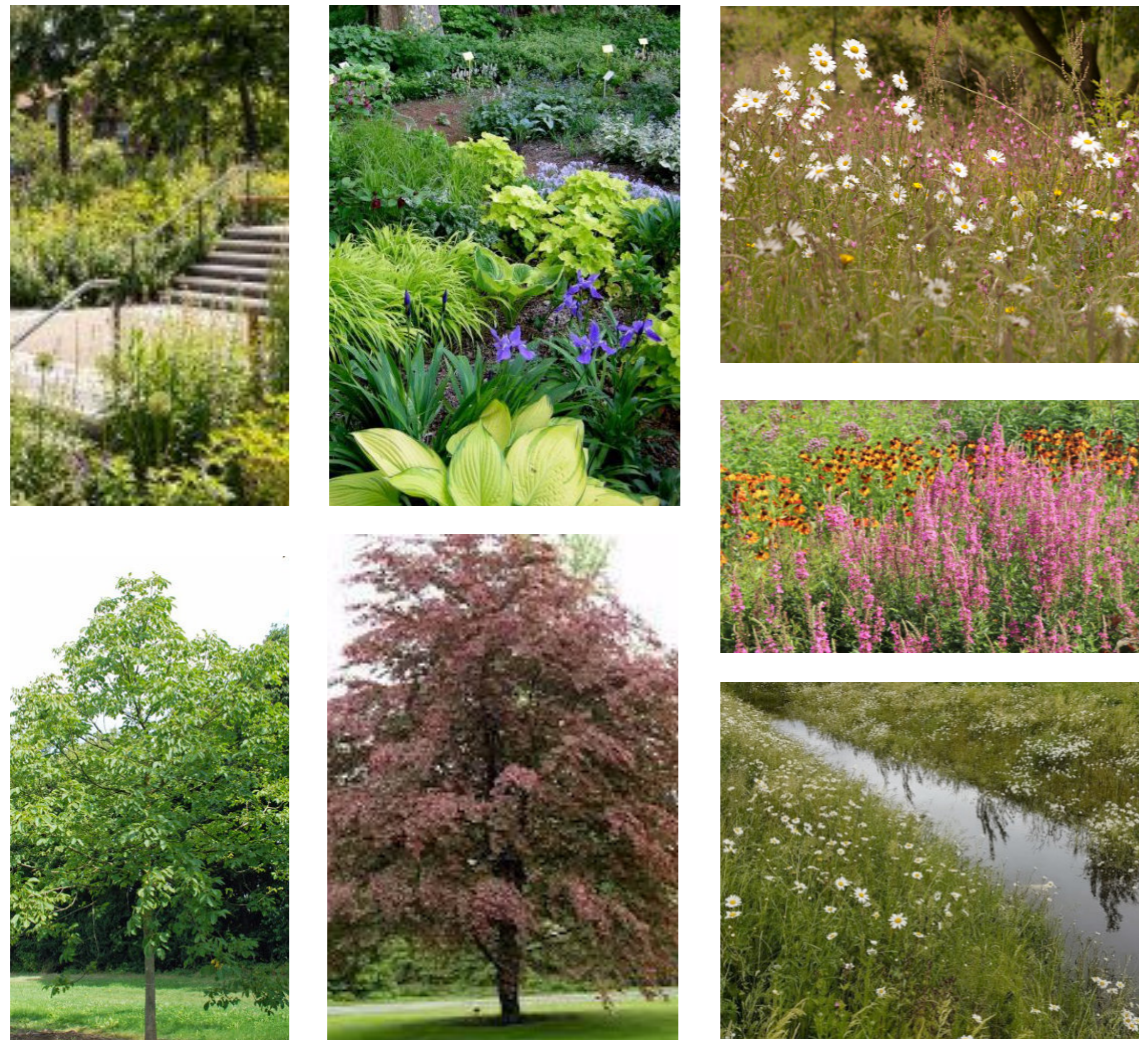

PLANTING EXAMPLES



Ramps and steps from Craigour Drive to Castleview House



New paths and entrance to park between Little France and Mary Tree



New ramps and planting from Goodtrees Terrace to Moncrieffe Houses



Next Steps

Contractor Involvement

The next step is to appoint a contractor. They will work with us on the detailed design and advise on the best way to phase the project.

Building Warrant

After that, we'll apply for a Building Warrant. This covers the technical aspects of the design, including the structure and compliance with regulations.

Construction

Once both the planning and building warrant applications are approved, the project can move into the construction phase.

Stay updated

Scan the QR code to see the latest project news on the council's project website.



INTERPRETATION AND TRANSLATION

If you require further information or wish to share your thoughts, please contact hrmi@edinburgh.gov.uk.

You can get this document on audio CD, in Braille, large print if you ask us. Please contact HRMI@edinburgh.gov.uk with your request. Our ITS service can also give information on community language translations.



HAPPY TO TRANSLATE