

# Development Management Sub-Committee

**10.00 am, Wednesday 18 November, 2015**

## **Stopping Up Order – Shrub Place Lane, Edinburgh**

<b>Item number</b>	4.4
<b>Report number</b>	
<b>Executive/routine</b>	
<b>Wards</b>	A12 - Leith Walk

### **Executive summary**

---

The purpose of this report is to request that the Sub-Committee confirm as unopposed The City of Edinburgh Council (Shrub Place Lane, Edinburgh) (Stopping Up) Order 2015 - PO/15/12.

### **Links**

---

<b>Coalition pledges</b>	
<b>Council outcomes</b>	CO25 – The Council has efficient and effective services that deliver on objectives.
<b>Single Outcome Agreement</b>	

# Report

## Stopping Up Order –

THE CITY OF EDINBURGH COUNCIL (SHRUB PLACE LANE, EDINBURGH) (STOPPING UP) ORDER 2015 - PO/15/12.

### Recommendations

---

- 1.1 That the Sub-Committee confirm as unopposed The City of Edinburgh Council (Shrub Place Lane, Edinburgh) (Stopping Up) Order 2015 – PO/15/12 (see Appendix 1 and 2).

### Main report

---

- 2.1 To facilitate grant of approval of full planning permission (reference below) a Stopping Up Order was made by the Council as listed hereto  
PO/15/12 Shrub Place Lane, Edinburgh (Planning Ref 05/03128/FUL).
- 2.2 The Stopping Up Order was made on 16 September 2015 and advertised on 18 September 2015. There are no outstanding objections to the Order.

### Measures of success

---

- 3.1 The planning permission will be implemented in full.

### Financial impact

---

- 4.1 Associated costs will be met by the applicants.

### Risk, policy, compliance and governance impact

---

- 5.1 All statutory procedures for the making and confirmation of the Order have been correctly followed.

### Equalities impact

---

- 6.1 None arising from this report.

## Sustainability impact

---

7.1 Not applicable.

## Consultation and engagement

---

8.1 Consultation period as required by the legislation has been carried out.

## Background reading/external references

---

Reports to the Development Quality Sub-Committee on  
Application 05/03128/FUL 18 December 2007

### David R. Leslie

Acting Head of Planning and Building Standards

Contact: John Murphy, Traffic Orders Administration Officer

E-mail: john.murphy@edinburgh.gov.uk | Tel: 0131 469 3660

## Links

---

### Coalition pledges

**Council outcomes** CO25 – The Council has efficient and effective services that deliver on objectives.

### Single Outcome Agreement

**Appendices** Appendix 1 – Stopping Up Order  
Appendix 2 - Plan

TOWN AND COUNTRY PLANNING (SCOTLAND) ACT 1997

THE CITY OF EDINBURGH COUNCIL (SHURUB PLACE LANE, EDINBURGH) (STOPPING UP) ORDER 2015 - PO/15/12

The City of Edinburgh Council, in exercise of the powers conferred on them by section 207 of the Town and Country Planning (Scotland) Act 1997, ("the 1997 Act") and of all other powers enabling them in that behalf, and being satisfied that it has become necessary to authorise the Stopping Up of the lengths of road specified in the Schedule to this Order to enable development to be carried out in accordance with planning permission granted under Part III of the 1997 Act, and having complied with the provisions of Section 209 of and Schedule 16 to the 1997 Act, hereby make the following Order:-

1. This Order may be cited as "The City of Edinburgh Council (Shrub Place Lane, Edinburgh) (Stopping Up) Order 2015".
2. The Interpretation Act 1978 shall apply for the interpretation of this Order as it applies for the interpretation of an Act of Parliament.
3. The stopping up of the lengths of road in the City of Edinburgh local government area specified in the Schedule to this Order is hereby ordered.
4. Where there is immediately before the date on which the said lengths of roads are stopped up under this Order, any apparatus belonging to any statutory undertakers under, in, on, over, along or across the length of road for the purpose of carrying on their undertaking, the said statutory undertakers shall after commencement of this Order continue to have all rights in respect of the said apparatus as they had immediately before that date.

Executed by The City of Edinburgh Council this Sixteenth day of September Two thousand and fifteen.

(witness)

Acting Head of Planning and Building Services

## SCHEDULE

### LENGTHS OF ROAD TO BE STOPPED UP

#### Shrub Place Lane

All that part of the road on Shrub Place Lane from the rear of the extended north-west footway on Leith Walk (Shrub Place) north-westwards,

- a) for a distance of 40 metres or thereby and which has a width throughout of 6 metres or thereby, and then
- b) for a distance of 54 metres or thereby and which has a width that varies from 4.5 metres or thereby to 5.5 metres or thereby.

All as the lengths of roads are shown hatched on the plan executed as relative to the Order.

---

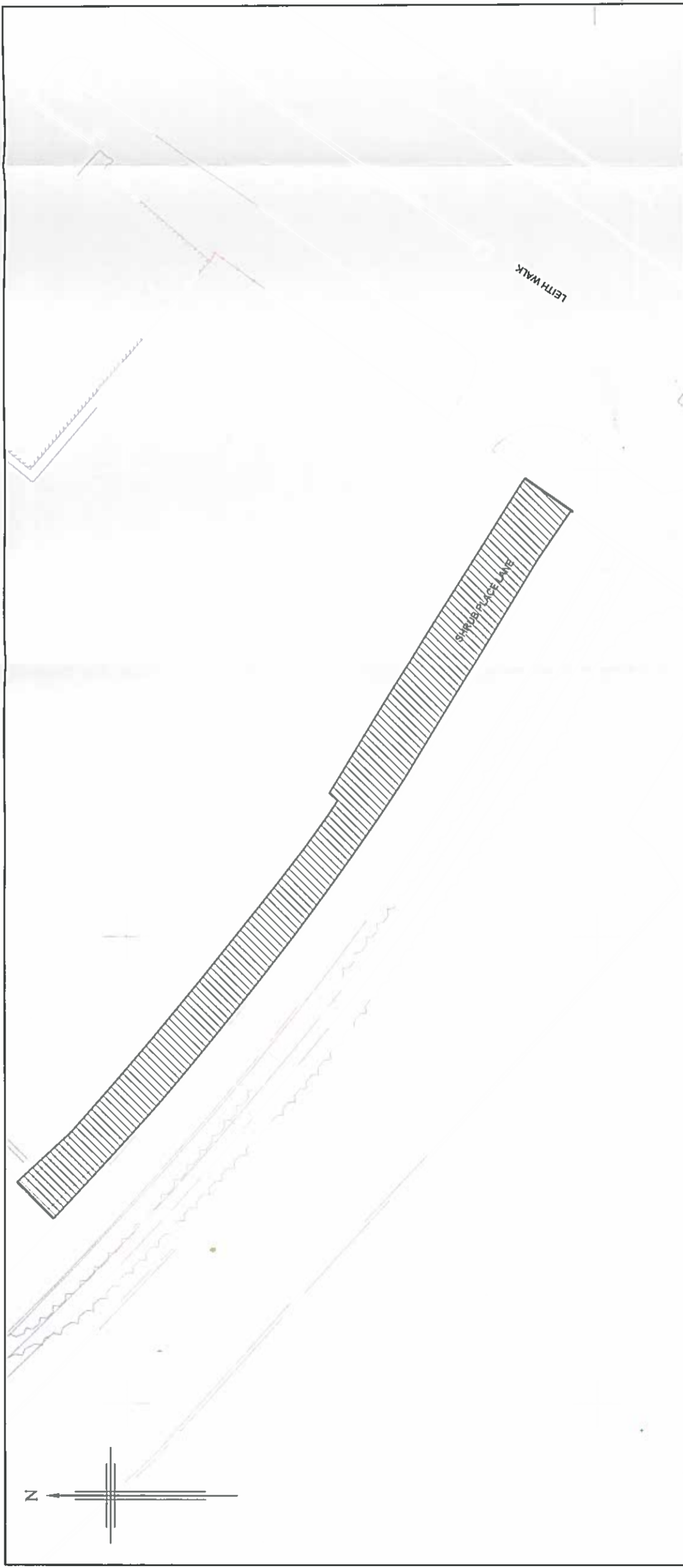

**NOTES**

1. THIS DRAWING IS COPYRIGHT, RESERVED AND REMAINS THE PROPERTY OF SCOTT BENNETT ASSOCIATES.
2. THE CONTRACTOR AND HIS SUBCONTRACTORS/ SUPPLIERS ARE TO VERIFY ALL DIMENSIONS AND LEVELS ON SITE BEFORE MAKING SHOP DRAWINGS OR COMMENCING MANUFACTURE.
3. THE CONTRACTOR IS TO BRING TO THE NOTICE OF THE ENGINEER ANY DISCREPANCIES OR AMBIGUITIES IN THIS DRAWING PRIOR TO WORK COMMENCING. WHERE REQUIRED THIS DRAWING TO BE READ IN CONJUNCTION WITH ALL RELEVANT DESIGN DRAWINGS & SPECIFICATIONS.
4. ALL WORK TO CONFORM TO THE RELEVANT BRITISH STANDARDS.
5. THIS DRAWING MUST BE READ IN CONJUNCTION WITH SCOTT BENNETT ASSOCIATES HAZARD & RISK ASSESSMENT DOCUMENT. THE CONTRACTOR SHOULD ENSURE THE H & R DOCUMENT IS AVAILABLE ON SITE FOR USE BY ALL SITE PERSONNEL.

 DENOTES AREA TO BE STOPPED UP.

REV	DESCRIPTION	BY	DATE
B	AMENDED TO COMMENTS RECEIVED FROM TRAFFIC ORDER'S MANAGER.	DS	14.07.15
A	DRAWING AMENDED TO RELATE TO STOPPING UP ONLY.	DS	13.07.15

**DOCUMENT**  
 We hereby certify this is a true and fair copy of the plan/drawing referred to in the application for Building Warrant.  
 Dated: \_\_\_\_\_ Signed: \_\_\_\_\_

CLIENT  



PROJECT  
 Proposed Development At  
 Shrubhill, Leith Walk.

TITLE  
 Stopping Up Order Plan  
 For Shrub Place Lane,  
 Edinburgh.

  
 Scott Bennett Associates  
 consulting civil and structural engineers  
 Scott Bennett Associates Group 11 Ltd  
 19 South Gyle Drive, Gyle, Edinburgh, KY11 1LP  
 T: 0131 6218171 F: 0131 6218171 E: enquiries@scottbennett.co.uk  

ISSUE STATUS  
 Approval

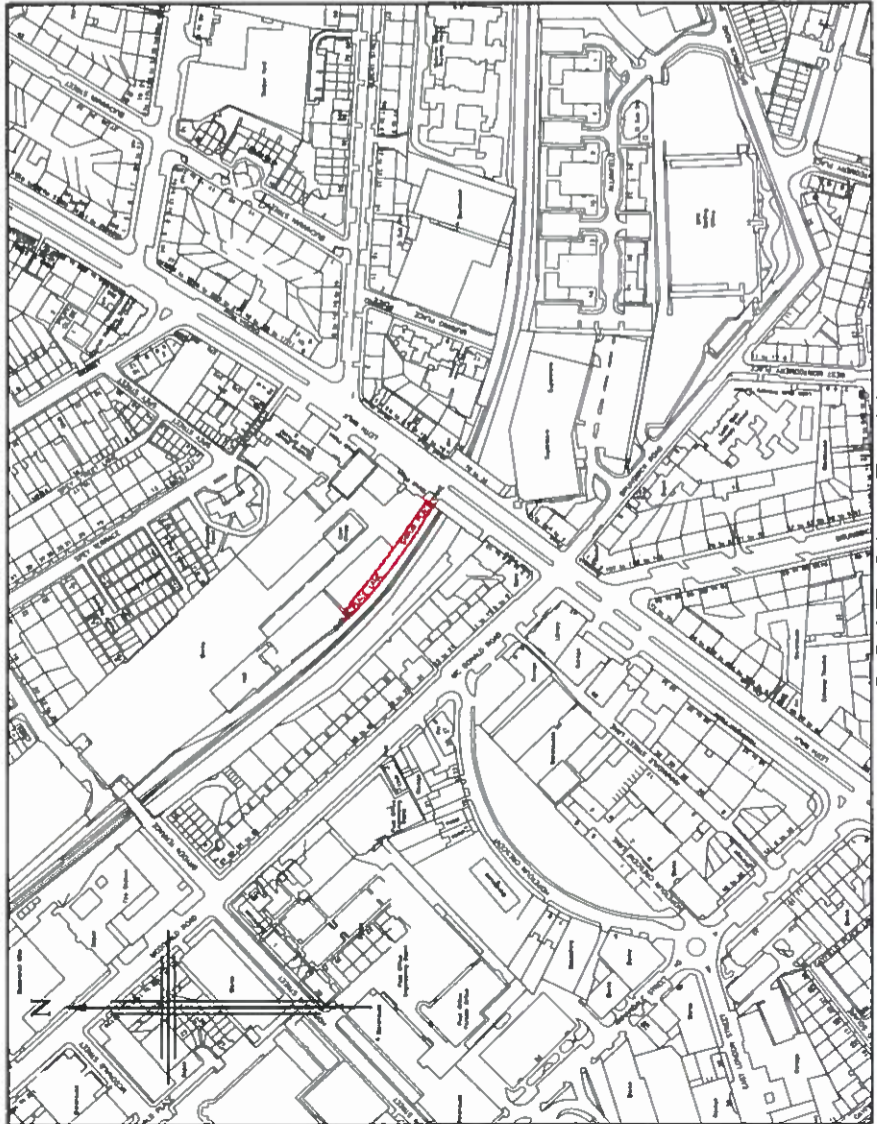
drawn	checked	date
DS	SAR	07.07.15
scales	1:500, 1:5000	sheet size A3
Drawing Number	J3031-050	
Revision	B	



**LOCATION PLAN**  
 (SCALE 1:5000)  
 NAT GRID REF.  
 NT263750/NT2638375013

**PLAN INDICATING EXTENTS REQUIRING STOPPING UP**  
 (SCALE 1:500)

THE CITY OF EDINBURGH COUNCIL (SHRUB PLACE LANE,  
 EDINBURGH) (STOPPING UP) ORDER 2015 - PO/15/12

Plan showing the lengths of road stopped up in terms of the above  
 Order. Executed by the City of Edinburgh Council on the Sixteenth  
 day of September Two thousand and fifteen.

(witness) Acting Head of Planning and Building  
 Standards