

The City Chambers

– FACILITIES/CAPACITIES –

ROOM NAME	THEATRE STYLE	CLASSROOM	U-SHAPE	BANQUET/ FORMAL DINNER/ CABARET STYLE	RECEPTION	BOARDROOM
Council Chamber	120	15/30/60	30	120	200	40
Including Gallery	175	-	-	-	-	-
Including lunch	90	-	-	-	-	-
Lunch in European Rm	100/120	-	-	-	-	-
European Room						
Without catering	90	12/24	26	60	110	40
With catering	60/70	9/18	20	50/60	110	-
Councillors' Lounge	-	-	-	14	70	-
Dunedin Room	-	-	-	24	-	27
Diamond Jubilee Room	-	-	-	24	25	30
Mandela Room	-	-	-	-	-	16
Dean of Guild Court Room	-	-	35	-	-	35
Dean of Guild Waiting Room	20	-	14	-	-	12

Business Centre						
Auditorium	60	6/12/18	up to 34	-	60	-
Breakout Area 1	-	12	-	-	60	-
Breakout Area 2/ Catering Area	-	14	-	-		-
Breakout Area 3	-	15	12	-		-

ROOM NAME	AV	POWER POINTS	NATURAL LIGHT	BLACKOUT BLINDS	LIGHTING EFFECTS
Council Chambers	Portable	10	Yes	Yes	Yes
European Room	Portable	7	Yes	Yes	Yes
Dunedin Room	Portable	3	Yes	Shutters	No
Diamond Jubilee Room	Portable	5	Yes	Shutters	No
Mandela Room	Static	3	Yes	Shades	Yes
Dean of Guild Court Room	Static	10	Yes	No	No
Dean of Guild Waiting Room	Portable	5	Yes	No	No
Business Centre	Static	5	Yes	Yes	Yes

The City Chambers

- ROOM PLANS -

BUSINESS CENTRE MAIN AUDITORIUM

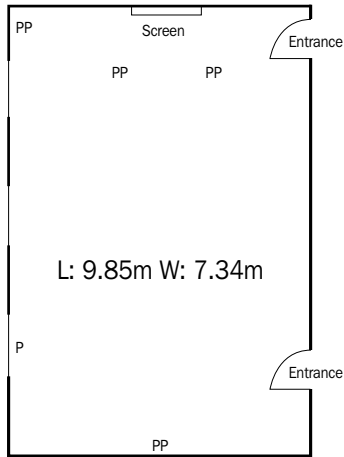

COUNCIL CHAMBER

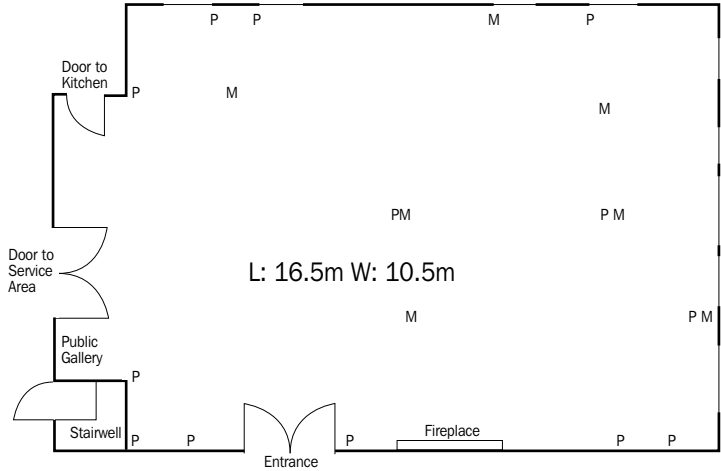

DUNEDIN ROOM

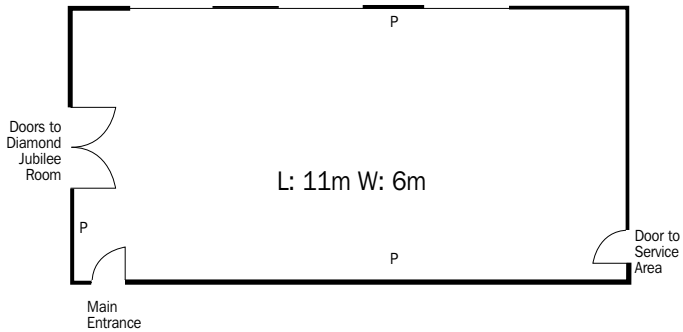

EUROPEAN ROOM

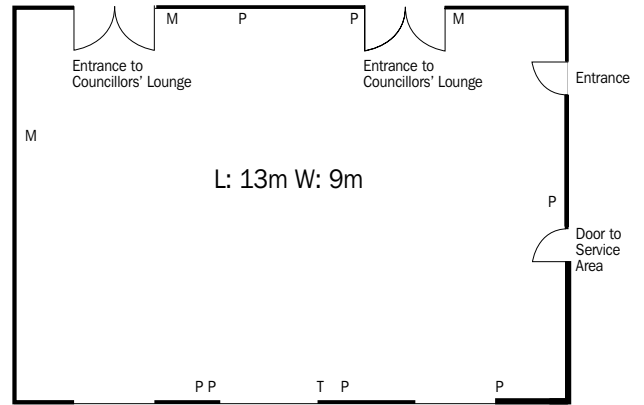

MANDELA ROOM

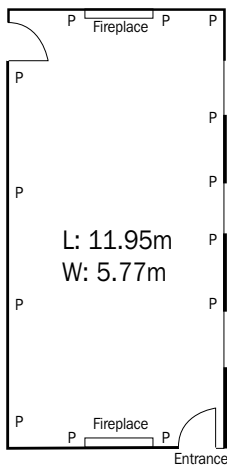

DIAMOND JUBILEE ROOM

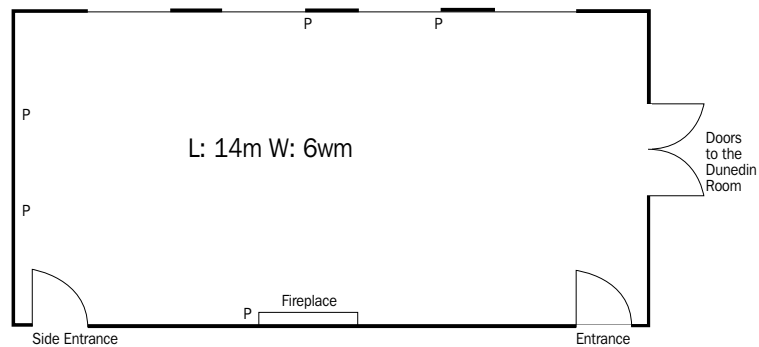

KEY	
Powerpoints	P
Sockets	M